

PATIENT STOOL COLLECTION INSTRUCTIONS

—READ ALL INSTRUCTIONS PRIOR TO COLLECTION—

- The testing requested by our provider requires the collection of a stool sample (bowel movement).
- Prior to collection discuss with your provider if any of the following apply to you during the past week:
 - Antibiotic use within the last week
 - Radiology exam that required you to take any of the following- barium, bismuth (Pepto Bismol), antidiarrheal medications (Lomotil, Imodium) or oily laxatives (Mineral Oil)

1 Wash hands and set out all of the items you will need to collect a stool sample.

- Collection hat
- Collection containers
- Biohazard bags

2  Write Patient Name, Date of Birth, time and date collected on the side of all specimen containers.

* Actual label may vary from image.



Void urine before placing hat. DO NOT mix urine, toilet water or toilet paper with sample.

3 Place stool hat in your toilet seat. To put the hat in place, lift up the toilet seat, place the hat over the bowl, and then close the toilet seat again. Position yourself on top of the portion of the bowl covered by the hat.

4 Follow the specific instructions listed next to the test(s) your provider has marked on the next page.



See specific container instructions on pg 2

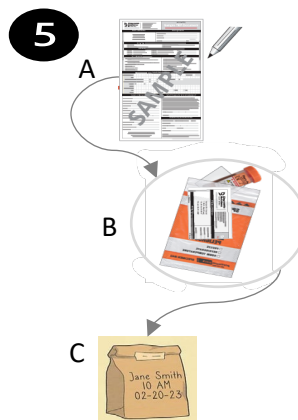

A) Place the Test Request Form into the document pocket of one of the specimen bags –and- page 2 of this document

NOTE: Be sure to write the date & time of sample collection on the form.

B) Check that the container is closed & place each container in their own biohazard bag & seal bag.

C) Place all specimen bags into a paper bag of same storage temperature. Storage temperatures are listed on page 2 next to the test selection

6 Drop off the stool samples and paperwork to one of the following locations AS SOON AS POSSIBLE or within 24 hours of collection.

OMAHA—

Oakview Medical Building

2727 South 144th St Suite 160

Omaha, NE 68144

P 402-778-5390 | F 402-559-9800

M to F 6:30am-5:30pm, Sat 7am-3 pm,

Sun closed

LINCOLN—

Regional Pathology Services-Central

300 N 44th St., Suite 110

Lincoln, NE 68503

P 402-559-2299 | F 402-805-4830

M to F 7am-6pm

Bellevue Medical Center Laboratory

2510 Bellevue Medical Center, Level 1

Bellevue, NE 68123

P 402-763-3202 | F 402-763-3180

M to F 6am - 6pm, Sat 6:30am-12:30pm

Sun closed

Regional Pathology Services-North

4911 N 26th St, Suite 108

Lincoln, NE 68521

P 402-559-2147 | F 531-530-1130

M to F 7:00am-8:30pm

All tests in this list can share the same container.

_____ **AGROTA** (Rotavirus, AG)
_____ **CALPRO** (Calprotectin)
_____ **CDIFD** (C. Difficile Toxin)
_____ **ELASTA** (Pancreatic Elastase)
_____ **HPYAG** (H. Pylori Stool)
_____ **NVDET** (Norovirus RNA)
_____ **STWBC** (WBC stool)

- Open the clean container.
- Fill with 5 mL of stool for each test selected on the left. Or fill container as full as possible.
- Tighten cap.



NOTE: Only liquid stools taking the form of the container will be accepted for CDIFD testing.

REFRIGERATE AS SOON AS POSSIBLE

All tests in this list can share the same container.

_____ **FECFAT**
(Fat, Fecal, Qualitative 'spot test')
_____ **LACTOF** (Lactoferrin)
_____ **SPH** (PH stool)

- Open the clean container.
- Fill with 5 mL of stool for each test selected on the left. Or fill container as full as possible.
- Tighten cap.



REFRIGERATE AS SOON AS POSSIBLE

Separate container is needed for each test marked in this box.

_____ **CRPTAG** (Cryptosporidium)
_____ **GAEIA** (Giardia)
_____ **MCYERS** (Yersinia)
_____ **GIP** (GIP Pathogen Panel)

- Open the Para-Pak Enteric Plus green vial and use the collection spoon built into the lid to place small scoopfuls of stool from the areas that appear slimy, bloody, or watery.
- FILL TO RED 'FILL' LINE
- Tighten cap and shake firmly to mix.



REFRIGERATE AS SOON AS POSSIBLE

_____ **STCULT**
(Stool culture)



- Open the Para-Pak Enteric Plus green vial and use the collection spoon built into the lid to place small scoopfuls of stool from the areas that appear slimy, bloody, or watery.
- FILL TO RED 'FILL' LINE
- Tighten cap and shake firmly to mix.

STORE AT ROOM TEMPERATURE

_____ **OPFEC**
(Ova & Parasite)



- Open the Proto-Fix vial with white lid and use the collection spoon built into the lid to place small scoopfuls of stool from the areas that appear slimy, bloody, or watery.
- FILL TO RED 'FILL' LINE
- Tighten cap and shake firmly to mix.

STORE AT ROOM TEMPERATURE

RPS Client Services
P 402-559-6420 | 800-334-0459
F 402-559-9497

Return to STEP 5